



# 5 Bank Street, Broadbottom, Hyde, SK14 6AY

A charming stone built mid terraced cottage property of character, standing on a no-through road in the heart of picturesque Broadbottom and offering deceptive living space arranged over four floors all just a short walk from the railway station which provides a 30 minute commute into Manchester City centre . Briefly comprising a front lounge with wood burning stove, a third bedroom or study, a dining room ,fitted kitchen and downstairs wc on the lower ground floor and then upstairs there is the main bedroom, a luxury period style bathroom with roll top bath and a 17ft attic bedroom with skylight windows. Split-level rear garden with garden shed. Energy Rating D

## £285,000

### Viewing arrangements

Viewing strictly by appointment through the agent

44 High Street West, Glossop, Derbyshire, SK13 8BH 01457 858888

#### Directions

From our office on High Street West proceed in a Westerly direction through the traffic lights, two roundabouts and along Dinting Vale. At the next set of traffic lights turn left into Glossop Road, continue through Gamesley and on into Charlesworth. In the centre turn right onto Long Lane, continue down the hill, over the bridge and up Lower Market Street into Broadbottom. Just after passing under the railway bridge turn right onto Gorsey Brow and then left into Bank Street where the property is on the left hand side.

#### GROUND FLOOR

##### Lounge

13'0 x 11'1 (to chimney breast)

Composite front door, pvc double glazed front window, central heating radiator, fireplace and wood burning stove, built-in cupboards and shelving, gas meter and glazed door through to:

##### Hallway

Spindled staircase leading to both the first and lower ground floor, pvc double glazed rear sash window and door to:

##### Bedroom Three/Study

10'4 x 7'0

Pvc double glazed patio doors and Juliet balcony, central heating radiator and laminate wood flooring.

#### LOWER GROUND FLOOR

##### Hallway

Central heating radiator, tiled floor and doors to:

##### Downstairs Wc

A white close coupled wc and pedestal wash hand basin, chrome finish towel radiator and storage cupboard.

##### Dining Room

10'2 x 6'5 (min)

Pvc double glazed rear sash window, central heating radiator, tiled floor and opening through to:

##### Kitchen

12'3 x 10'9

A range of fitted shaker style kitchen units including base cupboards and drawers, plumbing for an automatic washing machine, work tops over with an inset white ceramic one and a half bowl single drainer sink and mixer tap,

split-level gas hob and electric double oven, filter hood and matching wall cupboards, understairs cupboard, tiled floor, pvc double glazed rear sash window and composite external rear door.

## FIRST FLOOR

### Landing

Spindled balustrade and stairs leading to the second floor, pvc double glazed rear sash window, linen cupboard and doors to:

### Bedroom One

13'1 x 10'9 (to robes)

Pvc double glazed front window, central heating radiator, stripped floorboards, full length built-in wardrobes and cupboards.

### Bathroom

A period style four piece white suite including a freestanding roll top bath with ball and claw feet and mixer tap with shower attachment, wash hand basin with chrome finish wash stand, close coupled wc and corner shower cubicle, tiled floor, coloured towel radiator and pvc double glazed rear sash window.

## SECOND FLOOR

### Attic Bedroom

17'4 x 8'3

Partly restricted head height, front and rear Velux skylight windows, central heating radiator, shelved storage cupboard and laminate wood flooring.

## OUTSIDE

### Gardens

The property has a split-level rear garden with patio area and garden shed.

Our ref: Cms/cms/0801/25

### Agents Notes - HMRC Direc

To be able to sell or purchase a property in the United Kingdom all agents have a legal requirement to conduct Identity checks on all customers involved in the transaction to fulfil their obligations under Anti Money Laundering regulations. We outsource this check to a third party and a charge will apply. Ask the branch for further details.

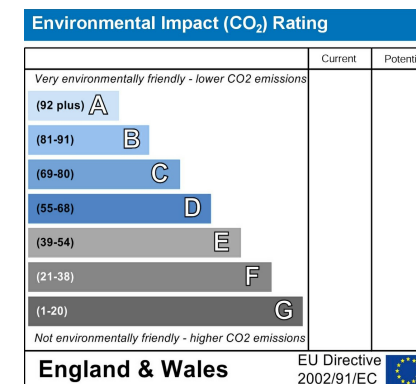
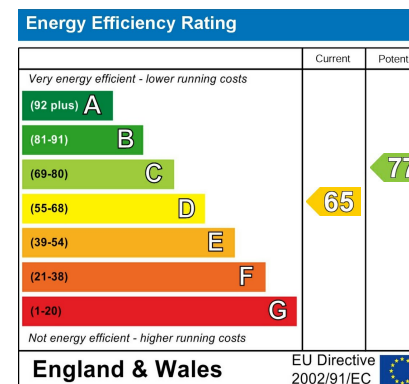



LOWER GROUND FLOOR



GROUND FLOOR

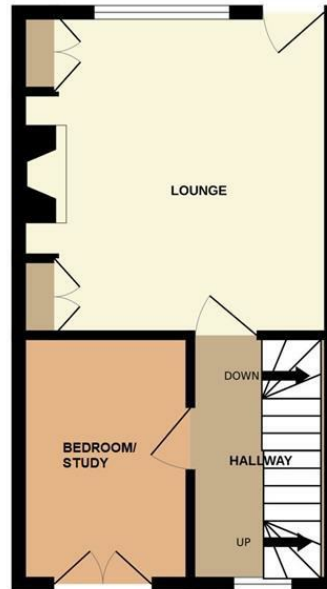

1ST FLOOR

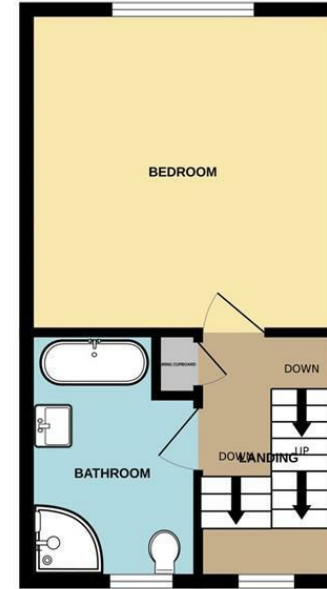

2ND FLOOR

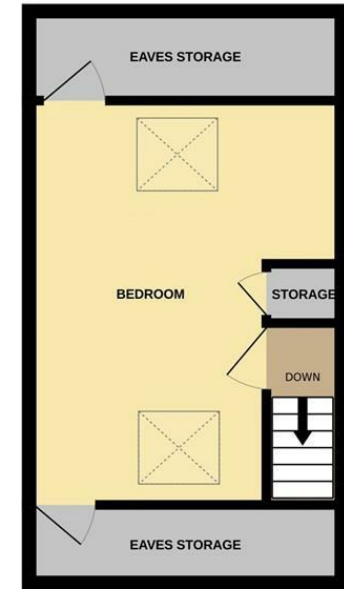

Whilst every attempt has been made to ensure the accuracy of the floorplan contained here, measurements of doors, windows, rooms and any other items are approximate and no responsibility is taken for any error, omission or mis-statement. This plan is for illustrative purposes only and should be used as such by any prospective purchaser. The services, systems and appliances shown have not been tested and no guarantee as to their operability or efficiency can be given.  
 Made with Metropix ©2025



These particulars are believed to be accurate but they are not guaranteed and do not form a contract. Neither Jordan Fishwick nor the vendor or lessor accept any responsibility in respect of these particulars, which are not intended to be statements or representations of fact and any intending purchaser or lessee must satisfy himself by inspection or otherwise as to the correctness of each of the statements contained in these particulars. Any floorplans on this brochure are for illustrative purposes only and are not necessarily to scale.

Offices at: Chorlton, Didsbury, Disley, Hale, Glossop, Macclesfield, Manchester Deansgate, Manchester Whitworth Street, New Mills, Sale, Wilmslow and Withington

44 High Street West, Glossop, Derbyshire, SK13 8BH

01457 858888

glossop@jordanfishwick.co.uk  
 www.jordanfishwick.co.uk

